



## *Thank you!*

Thank you for ordering a Downloadable WOOD PLAN. We hope you enjoy being a part of this new online experience and that you have fun building your wood-working project.

Please remember that this copyrighted material is for your use only. It is unlawful to share this file with someone else or to reprint it in any form.

Bill Krier  
Editor  
WOOD® magazine

### **Adobe Acrobat Troubleshooting Guide**

*If you can read this page, your Acrobat program is working correctly!  
But you may still have problems or specific issues such as printing and saving your Downloadable WOOD PLAN.*

#### **My printer won't print the text correctly**

Almost all printing problems are due to not enough free system resources memory. The files are very memory intensive since they include graphics, text, and photos. Close all other programs/applications and print directly out of the Acrobat Reader program, not your Web-browser.

#### **Patterns are not printing full size**

Make sure your printer is set to print at 100% and that "print to fit" is not checked. These settings are selected in the printer setup or printer options.

#### **I can't save my file now that it's downloaded**

You must save the plan when you download the file. Download the file again, except this time try right-clicking on the red download button. A menu window will open. Select "Save target as" or "Save link as" to save the file to your hard drive. Once saved, you can open it with Adobe Acrobat Reader.

For more details on using Adobe Acrobat Reader please visit our online help section at:  
<http://woodstore.woodmall.com/clicherforde.html>



# Swivel-Topped Tool Cabinet

Now, you can store two  
benchtop tools in one handy  
mobile unit.

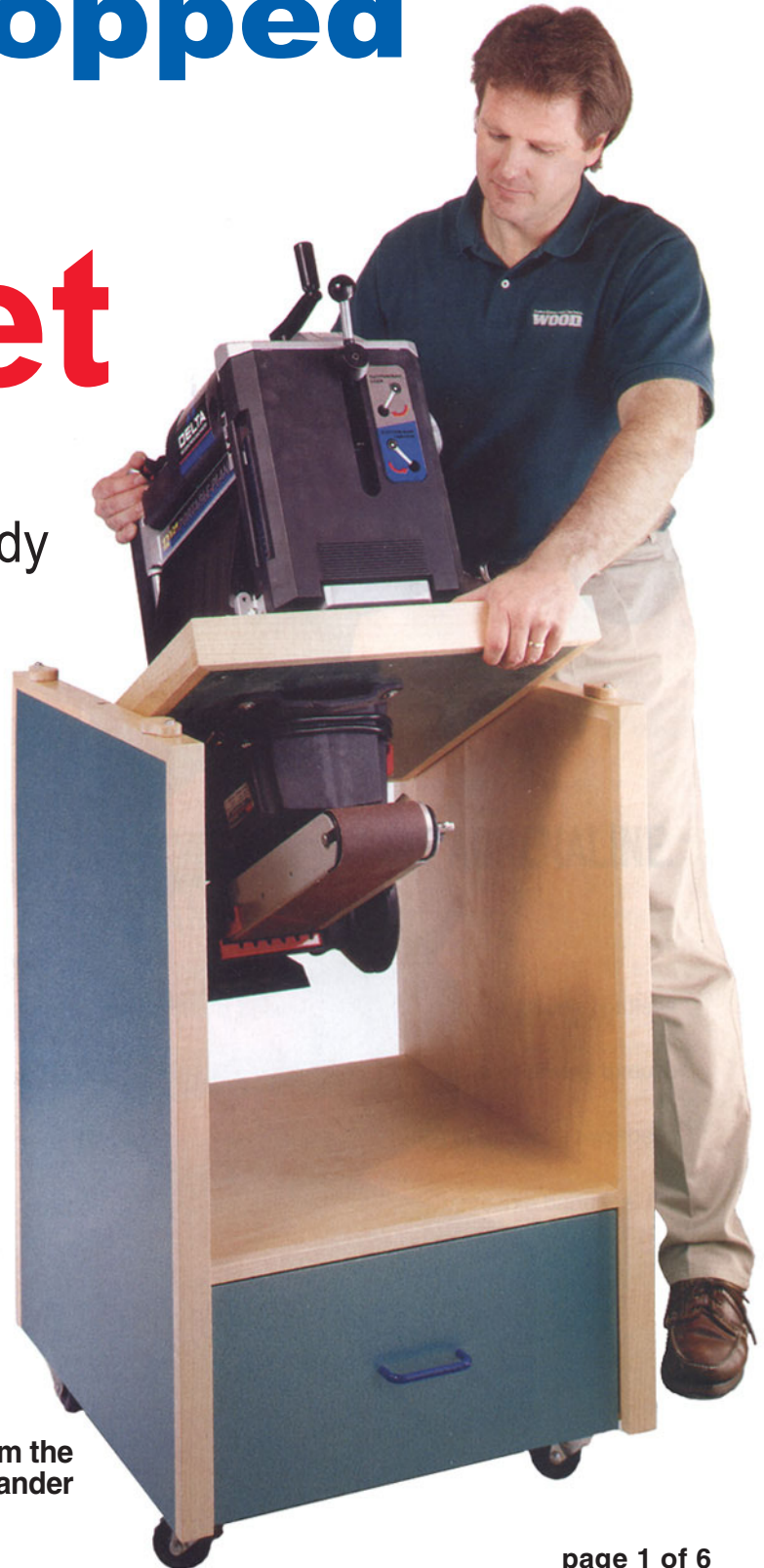

Senior Editor/How-To Marlen Kemmet demonstrates flipping the top to switch from the portable planer to the stationary belt/disc sander on our swivel-topped tool cabinet.

## Bill of Materials

Part	Finished Size			Mati.	Qty.	Part	Finished Size			Mati.	Qty.
	T	W	L				T	W	L		
<b>CARCASE</b>						<b>DRAWER</b>					
A sides	3/4"	22 1/2"	31 3/4"	BP	4	L sides	1/2"	8"	21"	C	2
B shelves	3/4"	21"	21"	BP	2	M front & back	1/2"	8"	18 1/4"	C	2
C back	3/4"	20"	10"	BP	1	N bottom	1/4"	19"	21"	BP	1
D banding	3/4"	3/4"	21"	M	2	O front	3/4"	9 7/8"	19 3/4"	M	1
E* banding	3/4"	1 1/2"	24"	M	2	*Cut parts marked with an * oversized. Trim to finished size according to the how-to instructions. <b>Materials Key:</b> BP—birch plywood, M—maple, C—choice of poplar or maple.					
F* banding	3/4"	1 1/2"	32 1/2"	M	4						
<b>SWIVEL TOP</b>						<b>Supplies:</b> #8x1", #8x1 1/4", #8x1 1/2" flathead wood screws; 2-2 1/2" locking swivel casters; 2-2 1/2" fixed casters; 16-#14x3/4" panhead sheet-metal screws with flat washers; one pair of 20" bottom-mount drawer guides (we used Knappe Vogt #1300 guides); 2-3/8" steel rods 2" long (or two 3/8x2" tension pins) with four 3/8" flat washers; 4-#10x1 1/2" panhead sheet-metal screws with four #10 washers; 3/4" wire pull; paint, clear finish.  <b>Buying Guide</b> <b>Hardware kit.</b> All the hardware listed in the Supplies listing above except for the finish. Kit no. WDTC, Miller Hardware, 1300 M.L. King Pkwy., Des Moines, IA 50314. Call 515/283-1724 for current price or to order.					
G center	3/4"	18 7/8"	21 3/4"	BP	1						
H* banding	3/4"	2 1/4"	22 1/2"	M	2						
I* banding	3/4"	2 1/4"	19 5/8"	M	2						
J top & bottom	3/4"	18 1/16"	20 15/16"	BP	2						
K turn tabs	1/2"	1 1/2"	2 1/2"	M	4						

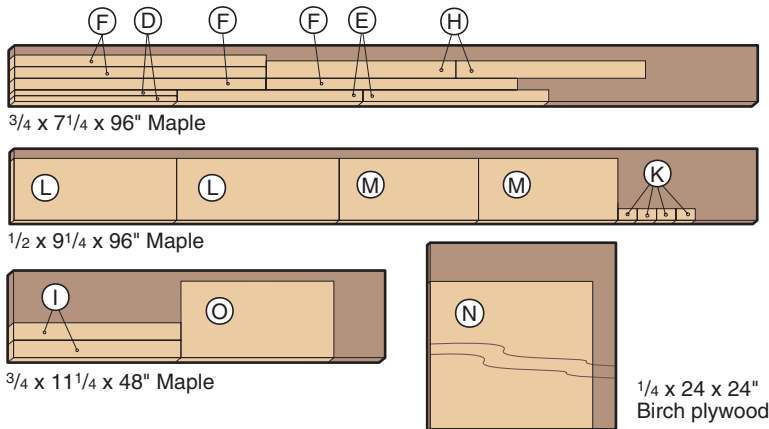

**CUTTING DIAGRAM**

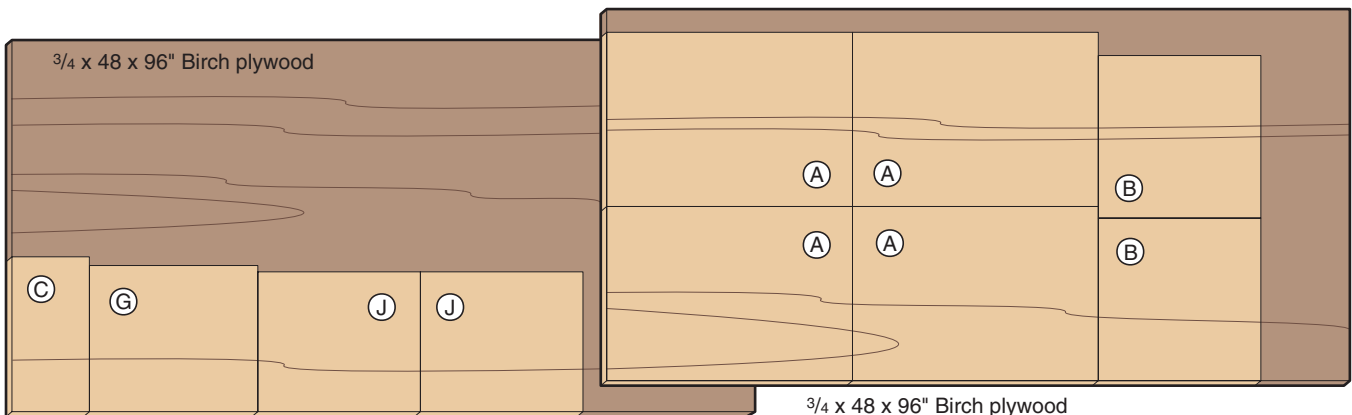

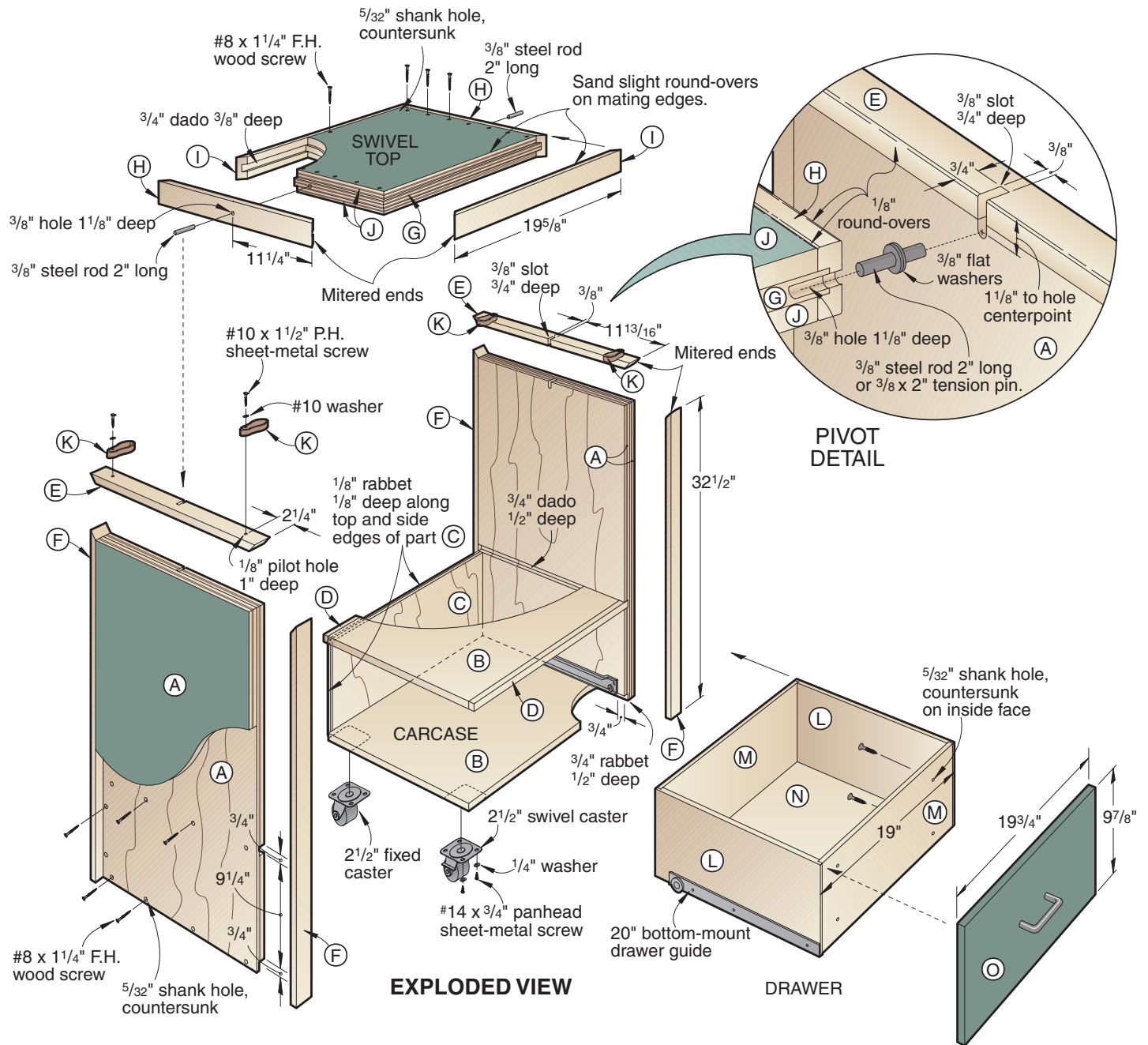

**Let's begin with the carcass assembly**

**1** Rip and crosscut the cabinet sides (A), bottom and middle shelves (B), and back (C) to the sizes listed in the Bill of Materials from 3/4" birch plywood.

**2** Mark the locations of the dado and rabbet on the inside face of two of the plywood side panels (A). Cut or rout them to the sizes listed on the Side Section View and Exploded View drawings. (We fitted our tablesaw with a dado blade and wooden auxiliary rip

fence. Then, we test-cut scrap pieces of plywood first to verify a snug fit of the mating plywood pieces in their respective rabbets and dados.)

**3** Band the front and back edges of the middle shelf (B) with banding strips (D) where shown on the Exploded View drawing.

**4** To match the reveal formed later between the drawer front (O) and carcass, cut or rout a 1/8" rabbet 1/8" deep along the top and side edges along the outside face of the back (C). See the Exploded View and Side Section

drawings for reference.

**5** Glue and clamp the shelves (B) and back (C) between the inside (machined) pieces (A), checking for square. Drill and countersink the mounting holes, and strengthen the assembly with screws.

**6** With the edges and ends perfectly flush, glue the outside (A) panels to the carcass assembly.

**7** From solid stock (we used maple), cut and miter-cut the banding pieces (E, F) to size, and glue and clamp them in place. Later, sand the surfaces flush.

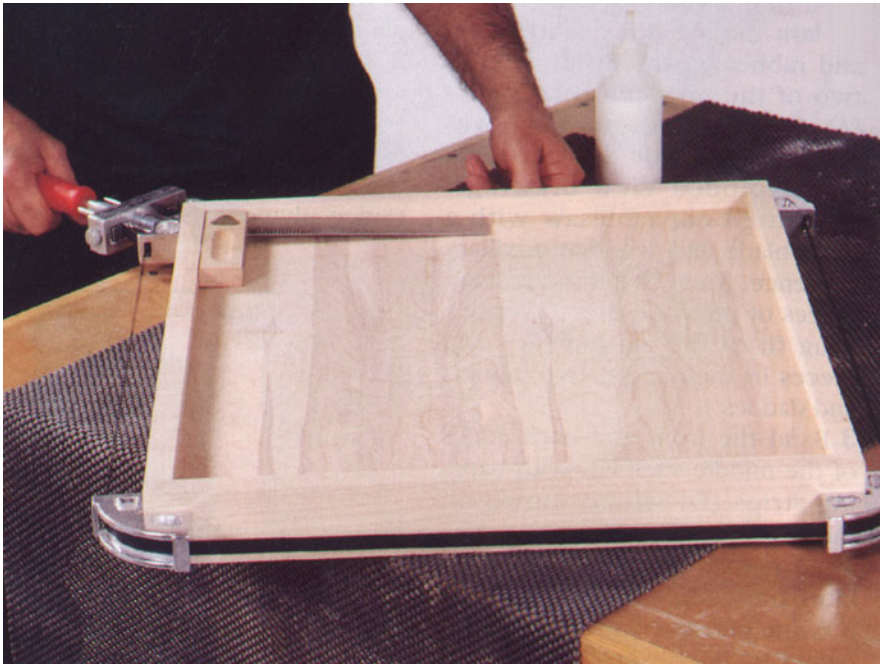

Check for tight miter joints, then glue and clamp the solid maple banding pieces around the plywood center section for the swivel top.

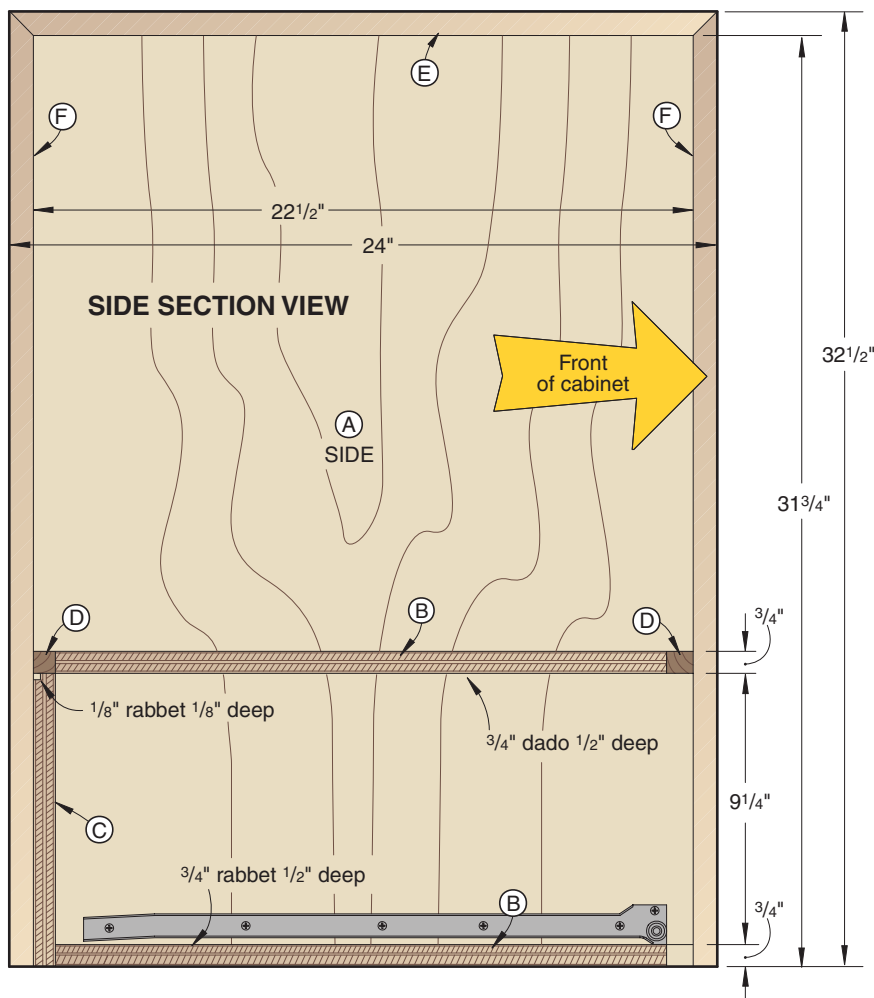

**8** Drill the mounting holes, and screw the locking swivel and fixed casters to the bottom corners of the bottom shelf (B).

### Now, construct the swivel top

**1** Cut the center  $\frac{3}{4}$ " plywood panel (G) for the top.

**2** Measure the combined thickness of three pieces of plywood you'll be using for the top (G, J). Cut the width of the top banding (H, I) to the measured thickness. (Since plywood is not exactly  $\frac{3}{4}$ " thick, you'll need to measure the thickness of the three pieces of plywood to determine the exact width necessary for the banding.) Crosscut the banding to the listed length plus 2".

**3** Cut a dado  $\frac{3}{8}$ " deep, centered along one face of each piece of banding (H, I), for the center top piece (G) to fit snugly into (we test-cut scrap stock first).

**4** Miter-cut the banding pieces (H, I) to wrap around part G.

**5** To ensure matching holes in the swivel top to those on the inside face of the cabinet, form a hole guide. To do this, cut a piece of  $\frac{3}{4}$ " stock to  $2\frac{1}{4}$ " wide by  $22\frac{1}{2}$ " long. Then, measure from end to end, and find the exact center of the strip, and mark a centerpoint. Use your drill press to drill a  $\frac{3}{8}$ " hole through the strip, and use this as a guide to drill a  $\frac{3}{8}$ " hole through each sidepiece H where shown on the Exploded View drawing. (Later, as shown in *Photo B*, we'll use the template to drill the mating holes in the cabinet sides.)

**6** Glue the banding pieces (H, I) in place around part G as shown in *Photo A*. Later, measure the openings, and cut the top and bottom pieces (J) to fit snugly inside the banding. Sand a slight round-over along the mating edges of the banding (H, I) and the top and bottom pieces (J) where shown on the Pivot detail accompanying the Exploded View drawing.

**7** Drill countersunk mounting holes, and screw the top and bottom pieces (J) in place.



For accurately placed holes in the swivel top and inside surface of the side panels, use a hole guide to locate the holes.

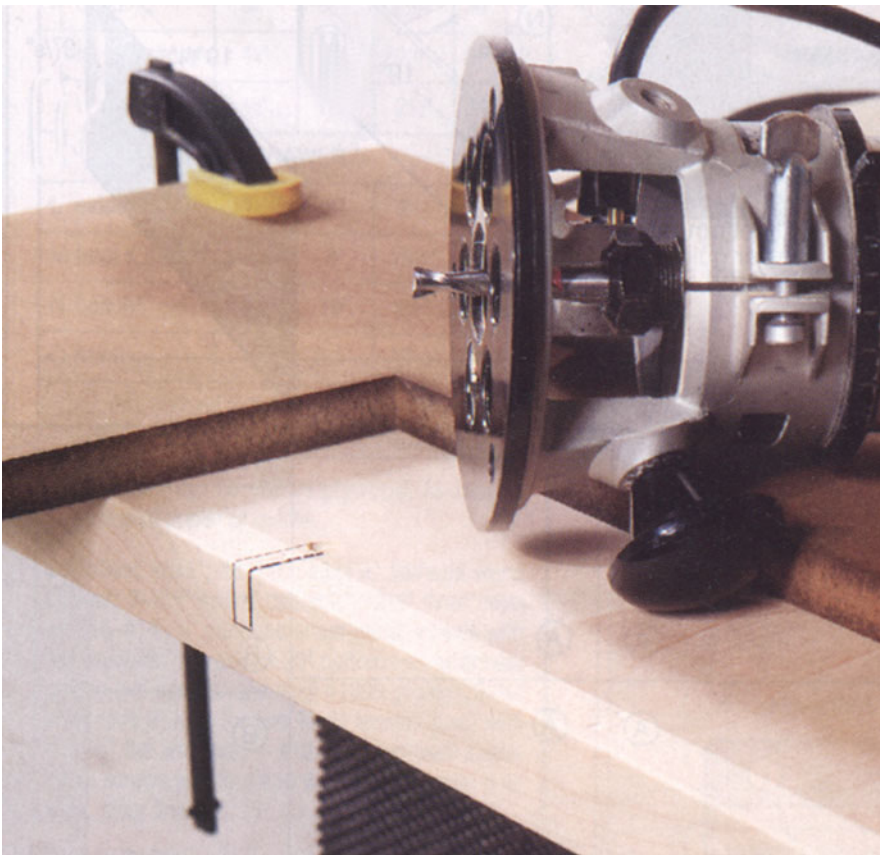

Using a  $\frac{3}{8}$ " straight bit and an L-shaped template, rout a  $\frac{3}{8}$ "-wide slot on the inside face of each side panel.

**8** Using the  $\frac{3}{8}$ " holes in both Hs as guides, drill  $\frac{3}{8}$ " holes into each F for a total depth of  $1\frac{1}{8}$ " where shown on the Pivot detail.

**9** Lay the cabinet on its side on your workbench. As shown in *Photo B*, clamp the hole template in place, and drill a  $\frac{3}{8}$ " hole  $\frac{3}{4}$ " deep into the inside face of the cabinet sides, centered perfectly from end to end.

**10** Using a square, carefully mark the location for the  $\frac{3}{8}$ " slot  $\frac{3}{4}$ " deep centered over the hole drilled in the previous step. For reference, see the layout lines in *Photo C*. Fit your router with a  $\frac{3}{8}$ " straight bit, and use an L-shape template as shown in *Photo D* to rout the slot to shape. Flip the cabinet over, and form the opposite slot.

**11** Cut two  $\frac{3}{8}$ " smooth steel dowel rods to 2" long each. Epoxy one into each  $\frac{3}{8}$ " hole in the top. See the Pivot detail for reference. Place two  $\frac{3}{8}$ " flat washers on each steel dowel rod, and place the swivel top in place.

**12** Transfer the full-sized turn tab (K) pattern and hole centerpoint to  $\frac{1}{2}$ " solid stock four times. Drill the  $\frac{3}{16}$ " holes where marked. Then, bandsaw or scrollsaw the turn tabs to shape. Sand or carefully rout a  $\frac{1}{8}$ " round-over along the top and bottom edges of each tab. Screw the turn tabs to the top of the top banding (E) where dimensioned on the Exploded View drawing. Tighten the screws so it takes just a small amount of pressure to rotate the tabs.

### Add a drawer for handy storage

**1** From  $\frac{1}{2}$ " stock (we prefer maple or poplar), cut the drawer sides (L) and front and back (M) to size.

**2** Drill four countersunk mounting holes through the back surface of the front piece (M) for attaching the solid drawer face (O) later.

**3** Cut a  $\frac{1}{2}$ " rabbet  $\frac{1}{8}$ " deep along the ends of each sidepiece where shown on the Drawer drawing.

**4** Glue and clamp the drawer parts (L, M) together, checking for square. Drill countersunk holes, then reinforce the joints with #8 $\times$ 1 $\frac{1}{2}$ " wood screws.

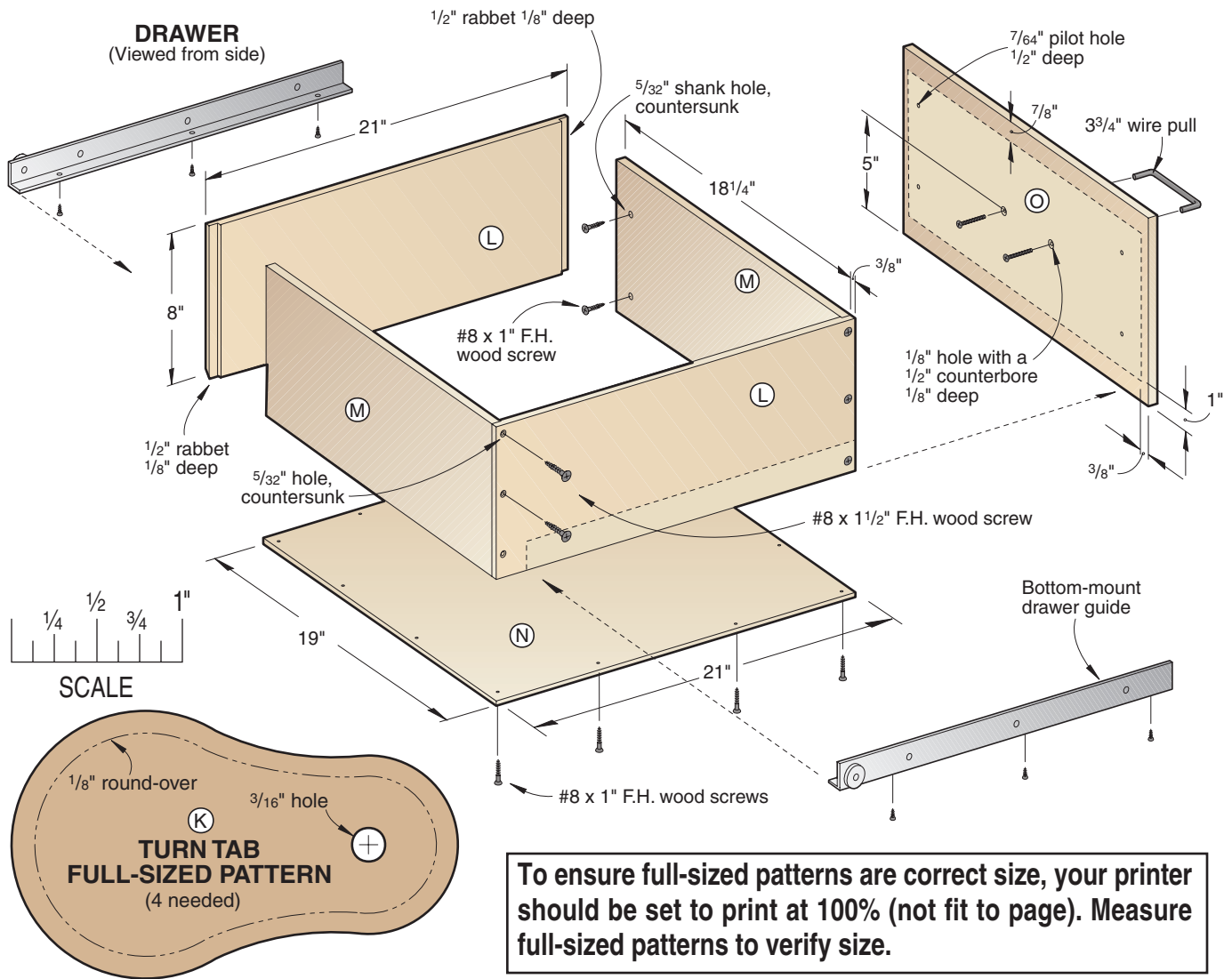

**5** Cut the bottom (N) to size, and glue and screw it in place, again checking for square.

**6** Attach the drawer guides to the drawer as explained in the manufacturer's instructions and where shown on the Exploded View drawing. Then, attach the mating guide pieces to the inside of the drawer opening.

**7** Cut the solid-stock drawer front (O) to size.

**8** Cut two pieces of double-faced tape to an inch long. Place the tape on opposite corners of the drawer front (M). Slide the drawer into the opening in the carcass. Carefully position the drawer front face (O) against the drawer front (M), centered in the opening. Push O against M to adhere it in place. Remove the drawer from the opening, and screw the face (O) to the front (M).

**9** Locate the centerpoints, and drill the holes for the drawer pull.

### Finish up the cabinet, and add a pair of tools

**1** Remove all the hardware and touch-up sand if necessary. Apply the paint and finish. (We used Hammerite for the painted surfaces and satin polyurethane on the rest where shown on the opening photo.)

**2** Reattach the hardware.

*Note: When releasing the turn tabs and rotating the top with the mounted tools, grab the ends (not the edges) of the swivel top to prevent accidentally pinching your fingers between the swivel top and carcass sides. A firm grasp also helps prevent the top from swiveling too quickly.*

**3** Mount your tools by centering them so the weight of each tool rests over

the pivot pins. Depending on the weight of the tools, you may want to secure them with bolts instead of screws. Also, when mounting the second tool, position it so the weight of the opposing tool is evenly distributed. This will prevent the top with attached tools from whipping around when you release the turn tabs. (We found it useful to have a helper on hand when locating and securing the tools to the swivel top.)

Produced by Marlen Kemmet  
 Project Design: Chuck Hedlund  
 Illustrations: Roxanne LeMoine, Lorna Johnson  
 Graphic Design: Jamie Downing  
 ©COPYRIGHT MEREDITH CORPORATION 1998

The purchase of these plans does not transfer any copyright or other ownership interest in the plans, the design, or the finished project to the buyer. Buyer may neither reproduce the plans for sale nor offer for sale any copies of the finished project.

# WOODMALL® The Internet's Largest Source for Woodworking Tools and Accessories

<http://www.woodmall.com>

## Thanks for your order!

Now that you've got a detailed plan to build that perfect project, visit the WOOD MALL for the internet's largest source for woodworking tools and accessories. The WOOD MALL offers:

- Over two dozen woodworking-related stores
- More than 50,000 tools & accessories
- 24-Hour shopping
- Special sales & closeouts
- Nearly 40 tool comparison charts
- **FREE** monthly woodworking seminar

Visit Today! <http://www.woodmall.com>



Current issue not shown

Like no other magazine, WOOD helps you make the most of your shop time ... takes your skills to the next level. Every issue of WOOD is jam-packed with ...

- Smart tips, tricks, secrets and shortcuts that save you time, effort and money
- Valuable tool reviews with at-a-glance information charts that give you helpful product comparisons
- Giant full-size pattern pull-outs
- Crystal-clear step-by-step instructions, exploded diagrams, finishing secrets and techniques for that professional look – everything you need to bring out your woodworking genius!

- 2 years (14 issues) just \$44 **SAVE \$39.30 off single-copy rate!**
- 1 year (7 issues) just \$26 **SAVE \$15.65 off single-copy rate!**
- Payment Enclosed     Bill Me

Fill out information below and mail to: WOOD® Magazine P.O. BOX 37439, Boone, IA. 50037-0439 or Subscribe Online at <http://www.woodmagazine.com/subscribe>

**My Name** (please print) \_\_\_\_\_

**Address** \_\_\_\_\_ **Apt. #** \_\_\_\_\_

**City** \_\_\_\_\_ **State** \_\_\_\_\_ **Zip** \_\_\_\_\_

**Canadian Orders:** Fill in the form above. Your rate will be 1 year (7 issues) for \$41 – SAVE \$14.65, or 2 years (14 issues) for \$67 – SAVE \$44.30. Prices include postage; 7% GST or 15% HST is added. #12348 2887 RT

**U.S. and Canadian subscribers:** You also may order by credit card. Call toll free 1-800-374-9663 weekdays from 7 a.m. to 10 p.m. Central Time; Saturdays, 8 a.m. to 3 p.m.; Sundays, 9 a.m. to 3 p.m.

**Other International Orders:** 2 years for \$89 U.S. or 1 year for \$49 U.S.; prices include postage. To order by credit card call 515/246-6952 during the same hours as listed above (toll charged). Or complete this form; mail with US funds to: WOOD® Magazine, P.O. Box 37439, Boone, IA. 50037-0439 USA.

**Your Money-Back Guarantee:** You must be satisfied with your subscription or you can get a refund for all unmailed issues.

WOOD® Magazine is published 7 times a year. Savings are based on \$5.95 U.S., \$7.95 Canadian single-copy rate. The first issue mails in 8-12 weeks. Subscription prices subject to change.